

# LP SERIES-GENERAL PURPOSE

## LP12-150 (12V150Ah)

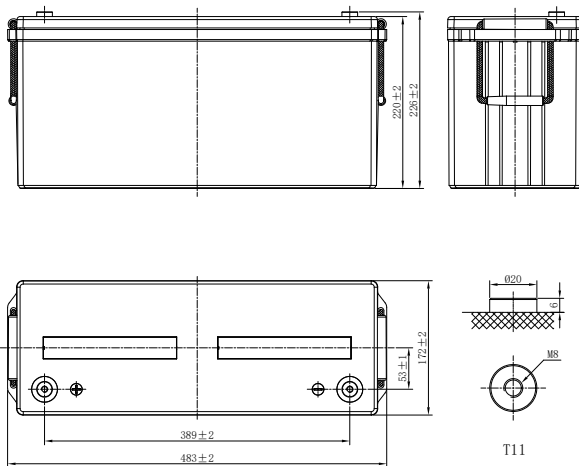

### CHARACTERISTICS

Item	Specifications	
Rated Voltage	12V	
Nominal Capacity (25°C)	C <sub>10</sub> , 1.80V/cell	150Ah
Dimension	Length	483mm(19.0inches)
	Width	172mm(6.77inches)
	Container Height	220mm(8.66inches)
	Total Height	226mm(8.90inches)
Approx Weight	41.9kg(92.4lbs)	
Terminal	T11(M8)	
Container Material	ABS (UL94 HB or V-0 optional)	
Short-circuit current	3000A	
Internal Resistance (25°C)	Approx 3.5 mΩ (Fully charged)	
Operating Temp. Range	Discharge	-15~50°C (5~122°F)
	Charge	-20~40°C (-4~104°F)
	Storage	-15~40°C (5~104°F)
Nominal Operating Temp. Range	25±3°C (77±5°F)	
Max. Charging Current (25°C)	0.3C	
Charge voltage (25°C)	Standby Use	Cycle Use
	2.25-2.30V/cell	2.35-2.40V/cell
Temp. Coefficient	-3mV/cell/°C	-5mV/cell/°C
	40°C (104°F)	103%
Effect of temp. to Capacity	25°C (77°F)	100%
	0°C (32°F)	86%
	≤3% per month at 25°C (77°F). LP series batteries may be stored up to 6 months at 25°C (77°F) and then a freshening charge is required. For higher temperatures the time interval will be shorter.	
Self Discharge		

### DISCHARGE TABLE

Constant Current Discharge (Amperes) at 25°C (77°F)																
F.V/Time	5min	10min	15min	20min	30min	45min	1h	1.5h	2h	3h	4h	5h	6h	8h	10h	20h
1.85V/cell	312.2	233.0	194.1	163.1	125.4	93.6	79.0	59.3	47.4	35.8	28.5	23.8	20.7	16.8	14.1	7.53
1.80V/cell	363.9	274.8	225.7	188.0	141.7	104.6	87.5	64.9	51.6	38.7	30.7	25.7	22.2	18.0	15.0	7.95
1.75V/cell	397.1	294.7	238.8	197.2	148.1	108.9	90.7	67.0	53.2	39.8	31.5	26.3	22.7	18.3	15.2	8.00
1.70V/cell	430.1	314.3	252.4	207.5	154.7	113.0	94.0	69.3	54.9	40.9	32.3	26.8	23.1	18.7	15.5	8.15
1.67V/cell	449.1	325.8	260.3	213.4	158.6	115.5	96.0	70.6	55.8	41.5	32.7	27.2	23.4	18.8	15.6	8.21
1.60V/cell	495.0	352.5	279.0	227.3	167.6	121.5	100.7	73.7	58.1	43.1	33.8	28.0	24.1	19.3	15.9	8.36
Constant Power Discharge (Watts/cell) at 25°C (77°F)																
F.V/Time	5min	10min	15min	20min	30min	45min	1h	1.5h	2h	3h	4h	5h	6h	8h	10h	20h
1.85V/cell	593.2	446.1	372.9	314.3	242.3	181.4	153.6	115.6	92.7	70.2	56.0	46.9	40.8	33.2	27.8	15.0
1.80V/cell	681.0	519.7	429.1	358.7	271.7	201.4	168.9	125.7	100.4	75.6	60.2	50.4	43.6	35.5	29.6	15.8
1.75V/cell	731.8	550.5	449.2	372.7	281.5	207.9	173.9	129.2	102.9	77.3	61.5	51.4	44.4	36.1	30.1	16.0
1.70V/cell	779.7	579.4	469.4	388.3	291.3	214.1	179.0	132.7	105.6	79.2	62.8	52.4	45.3	36.6	30.5	16.2
1.67V/cell	806.2	596.0	485.5	396.8	297.0	217.8	181.9	134.6	107.0	80.1	63.5	52.9	45.7	37.0	30.7	16.3
1.60V/cell	866.3	631.8	506.5	415.9	309.8	226.7	188.9	139.5	110.7	82.6	65.3	54.3	46.8	37.7	31.3	16.6

# LP SERIES-GENERAL PURPOSE

## LP12-150 (12V150Ah)



### APPLICATIONS

- All purpose
- Uninterruptable Power Supply (UPS)
- Electric Power System (EPS)
- Emergency backup power supply
- Alarm and security system
- Communication power supply
- DC power supply
- Auto control system

### GENERAL FEATURES

- 10 years design life (25°C)
- Lead calcium alloy, sealed design, no watering required
- Puncture resistant micro-porous glass mat separators extend life
- Unique technology optimizes power capacity, cell consistency, and long-term reliability
- Designed for a wide range of applications

### STANDARDS

- Compliance with IEC 60896 standards, EU Battery Directive
- UL, CE Approved
- Manufactured in Leoch@IATF 16949, ISO 45001, ISO 9001 and ISO 14001 certified production facilities

#### Discharge Characteristics

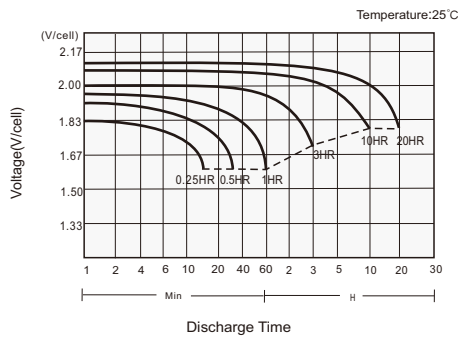

#### Charging Characteristics

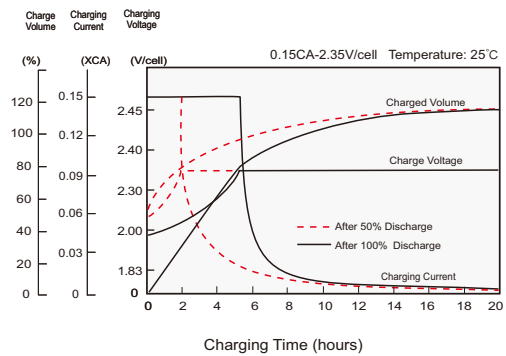

#### Effects of Temperature on Capacity

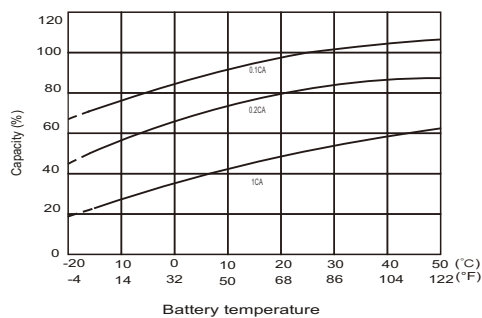

#### Self Discharge Characteristics

